



Birchbrook Lodge Birchbrook Road, Lymm, WA13 9RX

£1,250,000



Birchbrook Lodge Birchbrook Road, Lymm, WA13 9RX

£1,250,000

**** UNEXPECTEDLY BACK ON THE MARKET**** UNBELIEVABLE 1.25 APPROX ACRE PLOT WITH LARGE SIX BEDROOM DETACHED HOUSE AND DOUBLE GARAGE. Built nearly thirty years ago, this impressive detached home comprises a hallway, through lounge, wc/cloaks, study/playroom and large games room. There is a modern kitchen with granite work surfaces and island, diving area and open to a conservatory. There is also a useful utility room. Upstairs there is a master bedroom with ensuite, five further double bedrooms and a family bathroom. Externally the property is approached over a very long driveway leading around the house to the detached double garage. The grounds extend o approximately 1.25 acres and backs onto the Trans Pennine Trail.

Description



Council Tax Band: G

Floor Plans

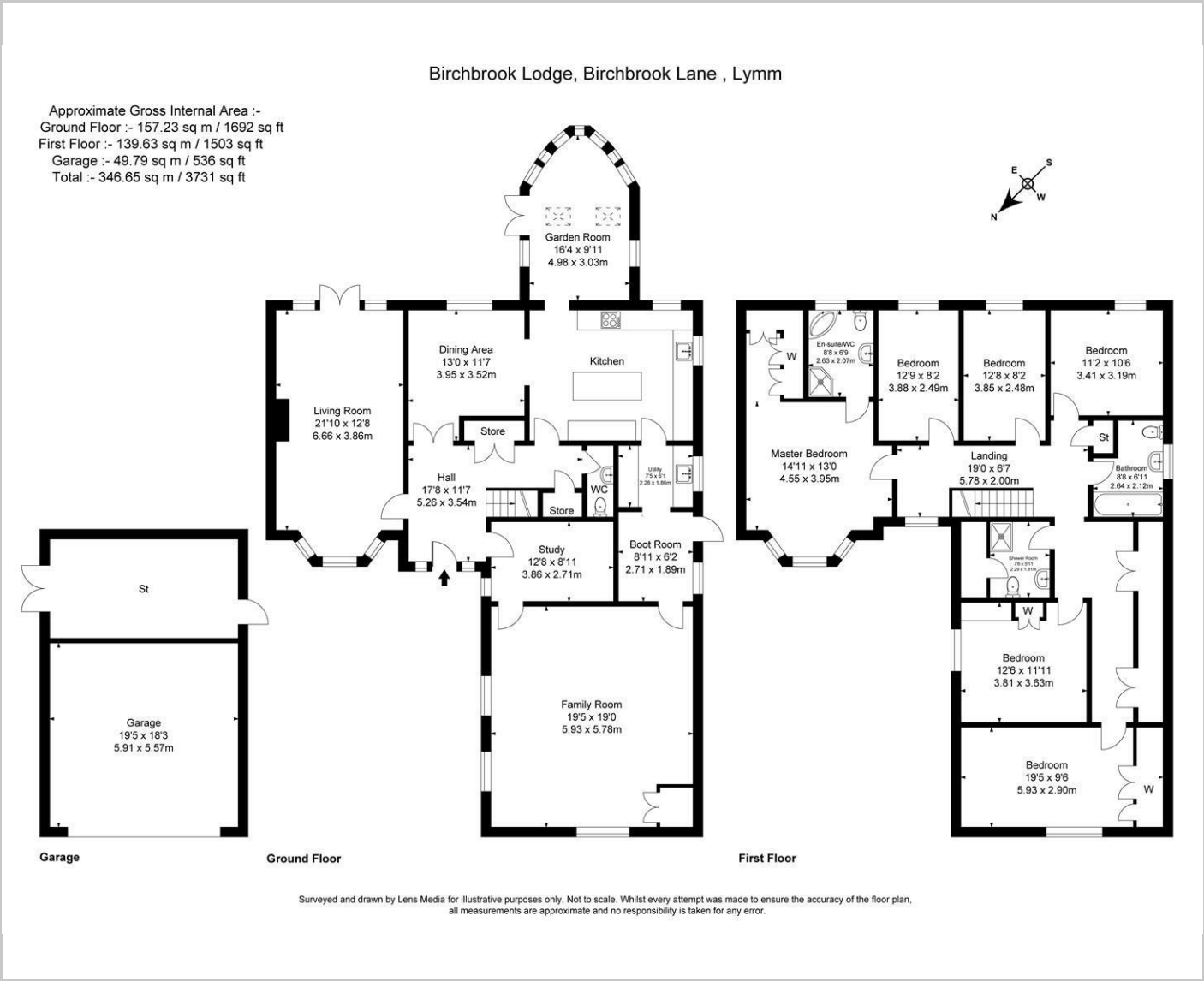

Area Map



Energy Performance Graph

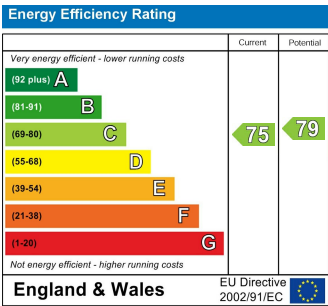

These particulars, whilst believed to be accurate are set out as a general outline only for guidance and do not constitute any part of an offer or contract. Intending purchasers should not rely on them as statements of representation of fact, but must satisfy themselves by inspection or otherwise as to their accuracy. No person in this firms employment has the authority to make or give any representation or warranty in respect of the property.